



**14th STREET, N.W.
TRANSPORTATION AND
STREETSCAPE
IMPROVEMENTS**



April 27, 2016

A decorative graphic consisting of three horizontal, wavy bands. The top band is red, the middle band is light gray, and the bottom band is dark blue.

**Infrastructure Project Management Administration
District Department of Transportation
with
Precision Systems, Inc.**

AGENDA

- Project Vision
- Project Objectives
- Project Location
- Project Schedule
- Project Approach
- Streetscape Elements
- Rendering of Improvements
- Maintenance of Traffic

PROJECT VISION

- **Increase Multi-Modal Safety Accessibility**
- **Improve Mobility and Pedestrian Safety with ADA Compliance**
- **Improve the Corridor with New Streetscape**

PROJECT OBJECTIVES

- **Transportation Improvements**
 - bus bulb-outs
 - ADA compliance (ramps, vaults and access to buildings)
 - landscaping; trees
 - curbs & gutters
 - drainage improvement
 - sidewalks / crosswalks
 - bicycle facilities
 - streetlights & traffic signals
 - multi-space parking meters
 - roadway resurfacing
- **Low Impact Development (LID) / Best Management Practices (BMP)**

PROJECT LOCATION

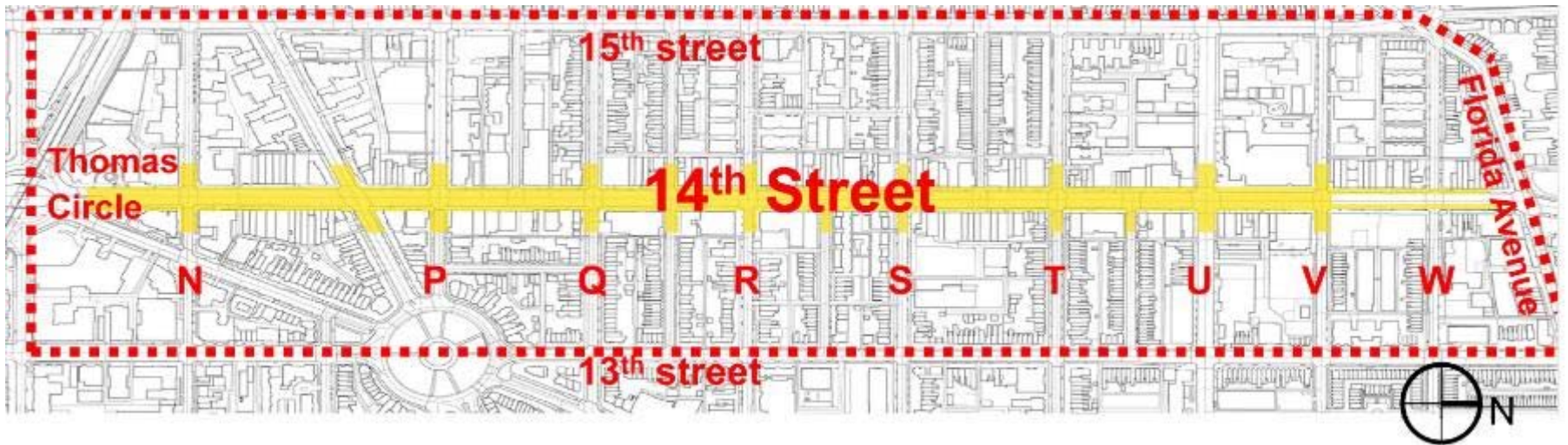

- 14th Street, N.W. from Thomas Circle to Florida Avenue

PROJECT SCHEDULE AND BENCHMARK

- Project Initiation – *Apr 2015*
- 90% Design Submittal – *Oct 2015*
- **Public information meetings** – ***Apr 2016***
- Final Design Submittal – *Jun 2016*
- Advertising for Construction – *Aug 2016*
- Construction – *Dec 2016*
- Construction Completion – *Dec 2017*

PROJECT APPROACH

Multiple Modal Transportation

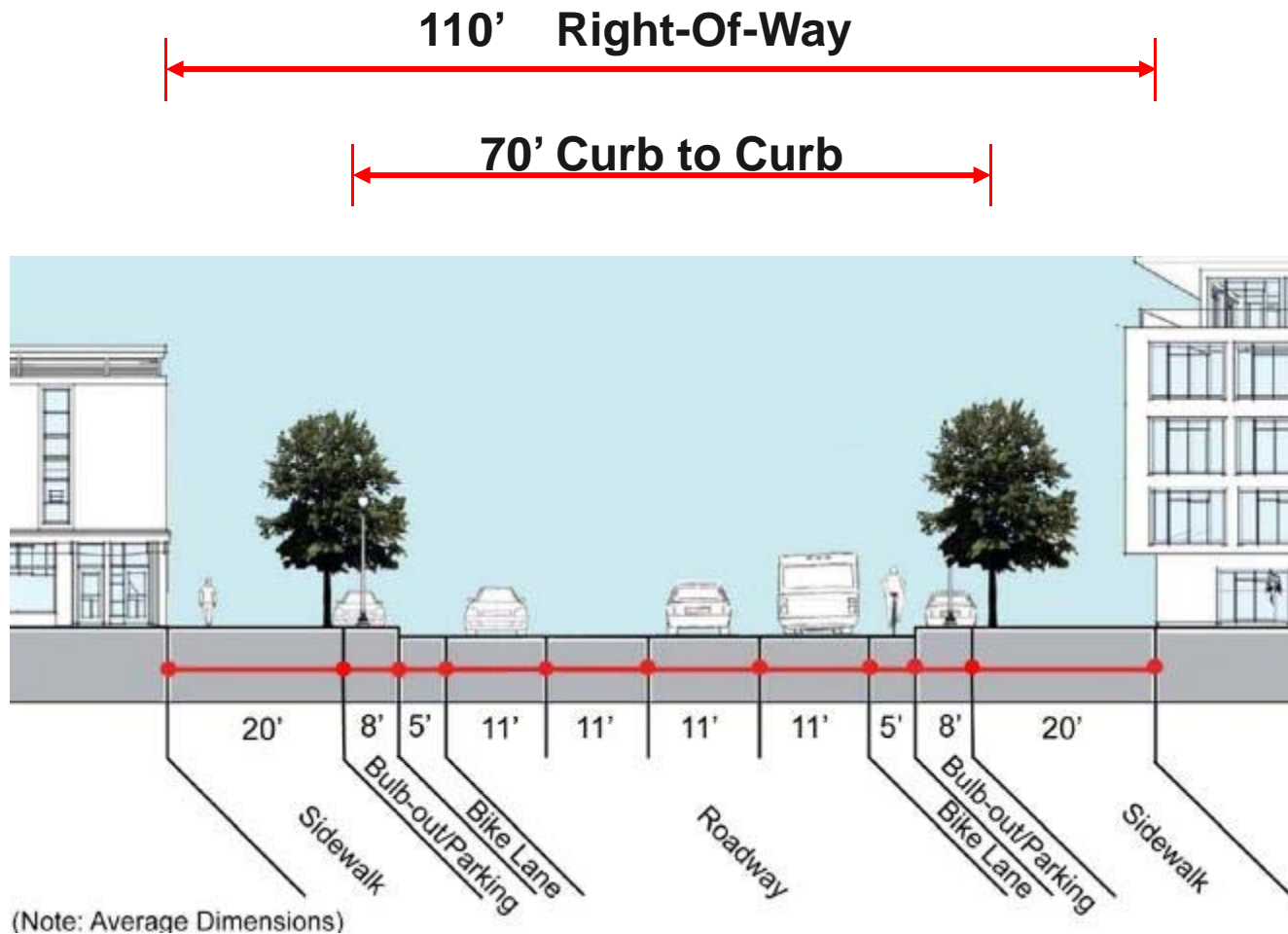

PROJECT APPROACH

Intersection Design for Multi-Modal Transportation

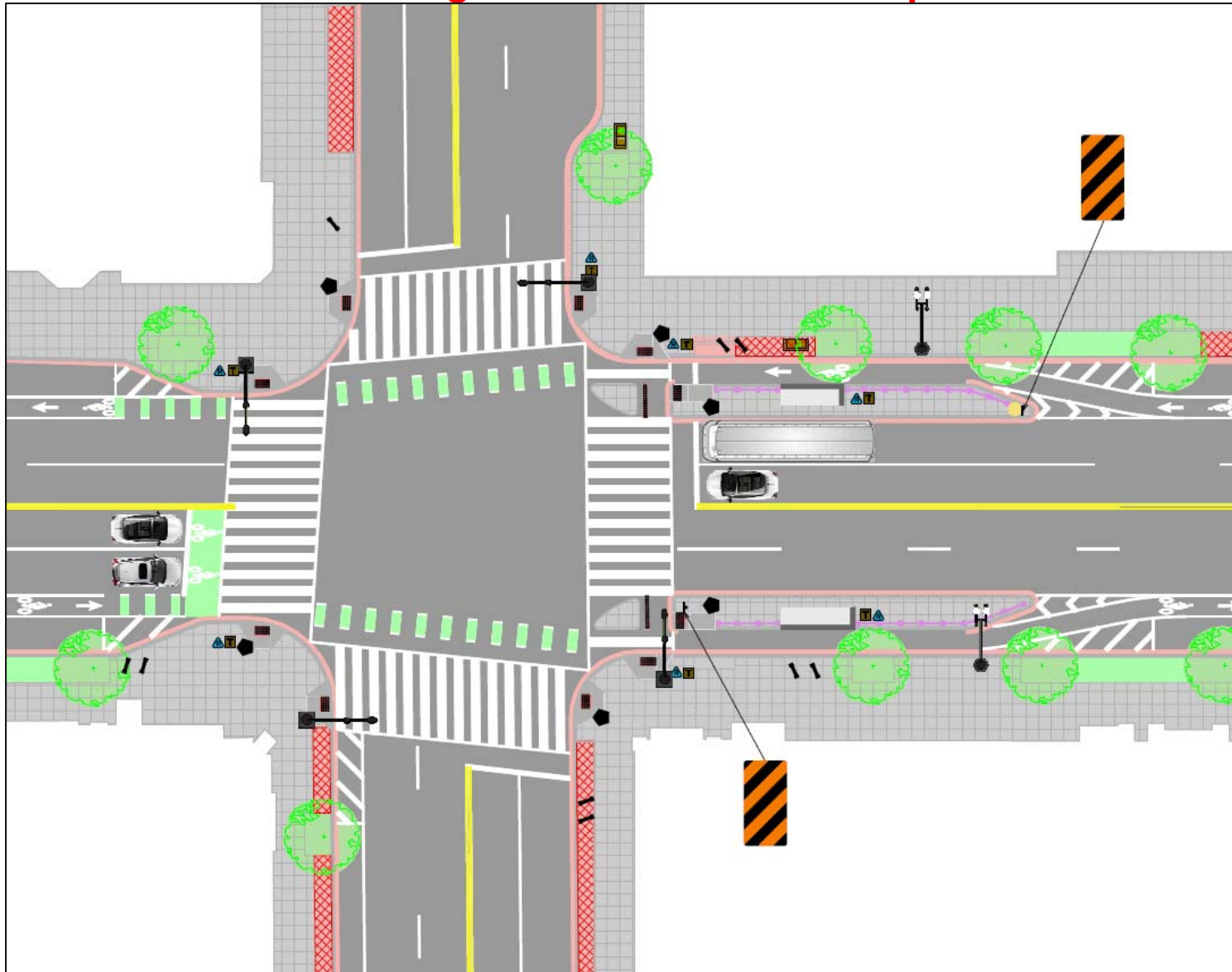

PROJECT APPROACH

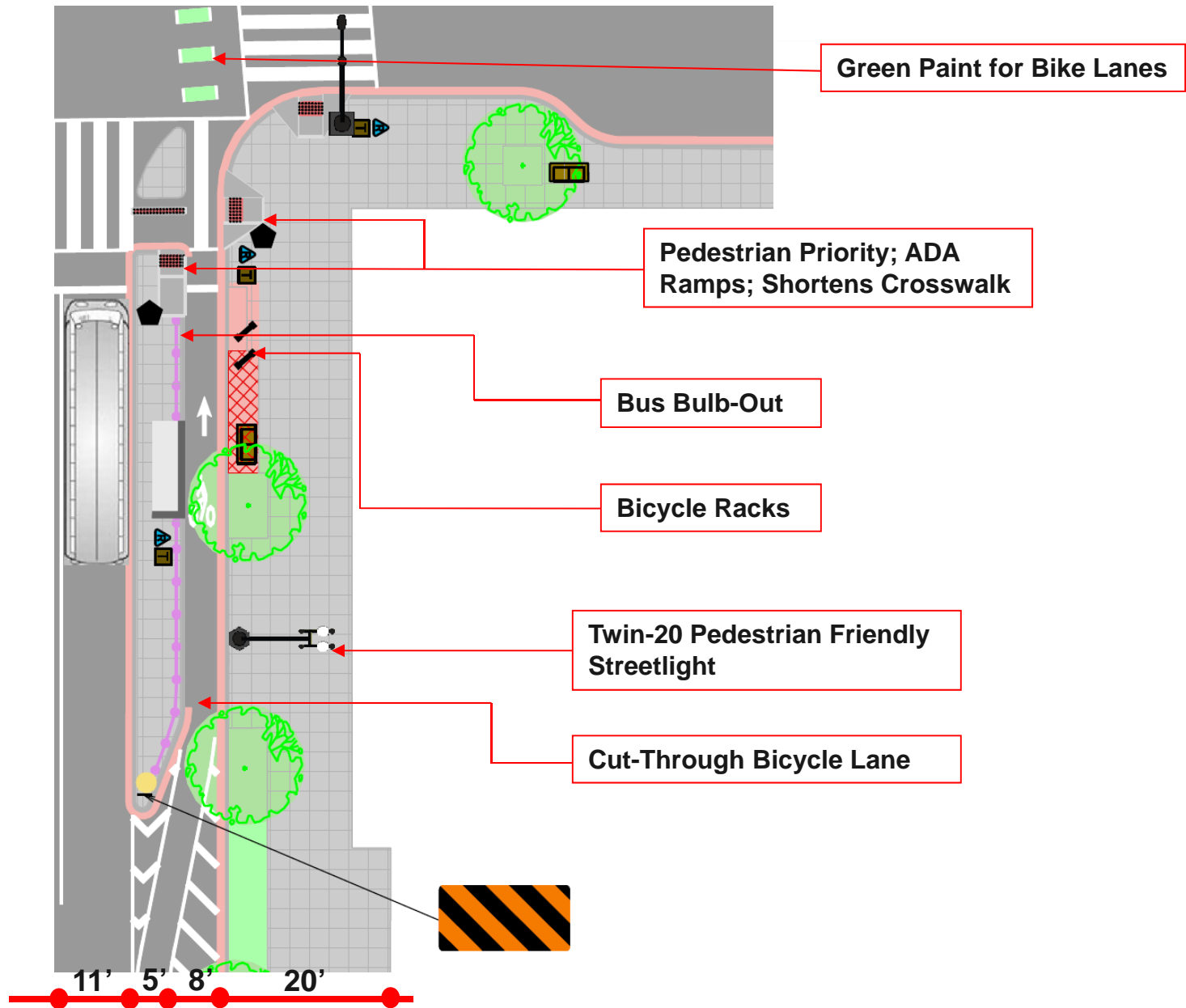

STREETSCAPE

**Existing Cobra-Head
Streetlights**

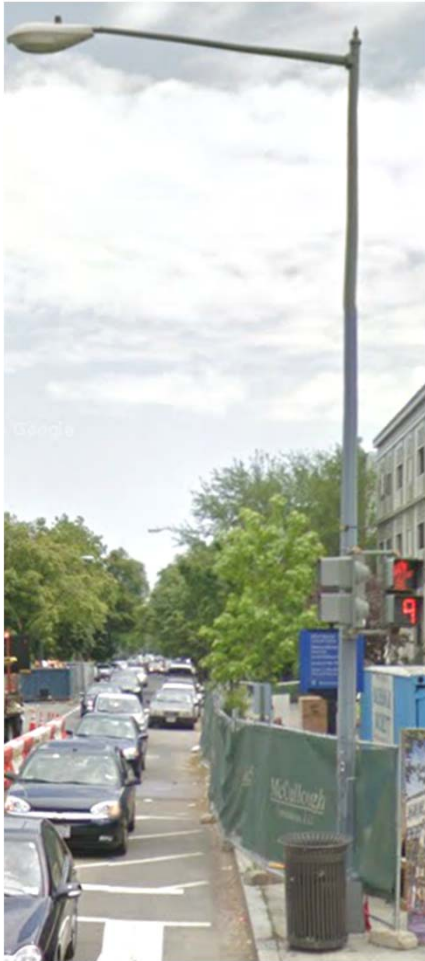

**Proposed Teardrops
At Intersections**



**Proposed Twin-20s
At Mid-Blocks**



STREETSCAPE

Existing Parking Meter



**Proposed Multiple Space
Parking Meter**



STREETSCAPE

Existing Curb Ramp



**Proposed ADA Compliant
Curb Ramp**



STREETSCAPE

Existing Building Vault



Proposed Building Vault



STREETSCAPE

Existing Special Crosswalk



Proposed High Visibility Crosswalk



STREETSCAPE

Ground Paving System



Bicycle Box in Green AC



Concrete / Cobble Stone Sidewalk



Flexible Porous Pavement at
Narrow and/or Damaged Sidewalks
Along Trees

STREETSCAPE

Low Impact Development (LID)

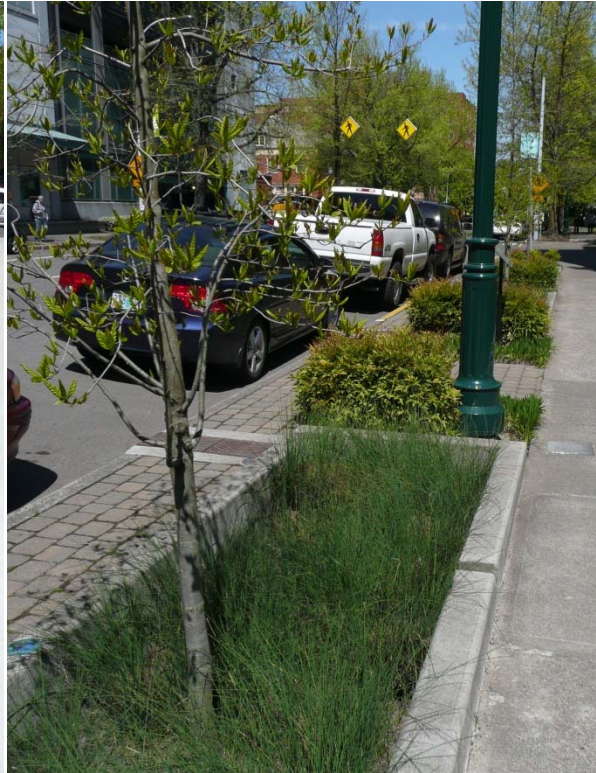

Flow Through Planters and Bio-Retention Facilities (Example Images)

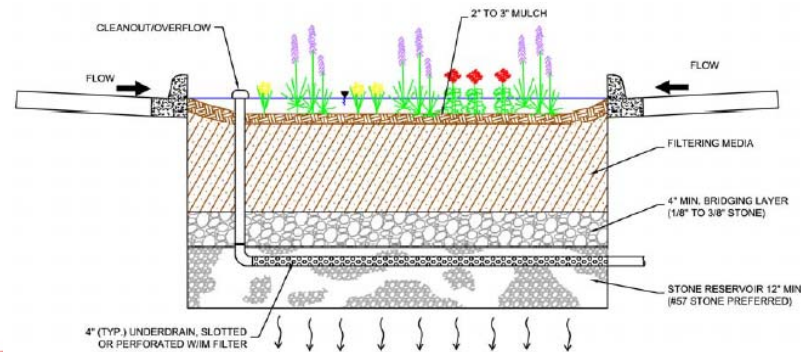

STREETSCAPE

BICYCLE RACKS



TRASH RECEPTACLES



BENCHES



STREETSCAPE

Street Tree Recommendation



Quercus Phellos,
Willow Oak



Plantanus Acerifolia,
London Planetree



Quercus Nuttallii
Nuttall Oak



Quercus Palustris,
'Crownright' or
'Sovereign' Pin Oak

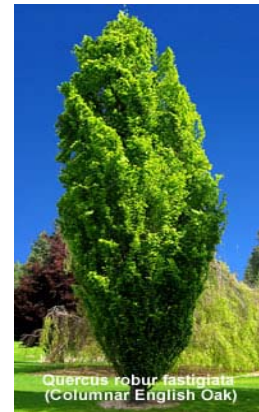

Quercus Robur
'Fastigata', Columnar
English Oak

PROJECT MAINTENANCE OF TRAFFIC (MOT) PLAN

A MOT Plan ensures that there is minimal impact on the existing road network, access to all properties, and adequate provisions are provided for pedestrians.

PROJECT CONSTRUCTION SEQUENCE



Legend

- 2 Maintenance of Traffic (MOT) Phasing

Sequence of Work:

- a) Streetlight and Traffic Signal (Trench & Conduit)
 - b) Drainage Catch Basins
 - c) Curbs and Gutters
 - d) Sidewalks
 - e) Milling and Overlay
 - f) Landscape
 - g) Pavement Markings
- } Follows Phasing Above

MOT DETAILS

Bulb-Out Construction

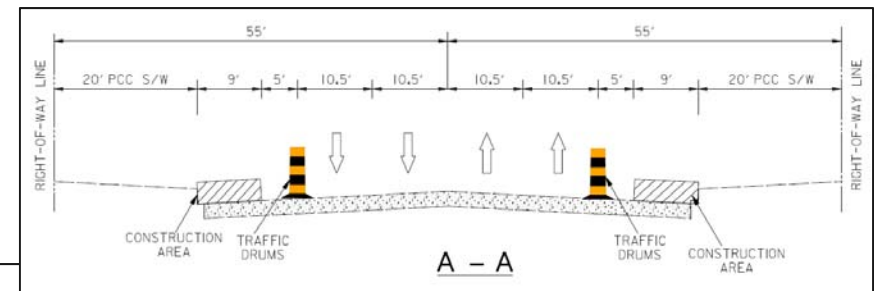
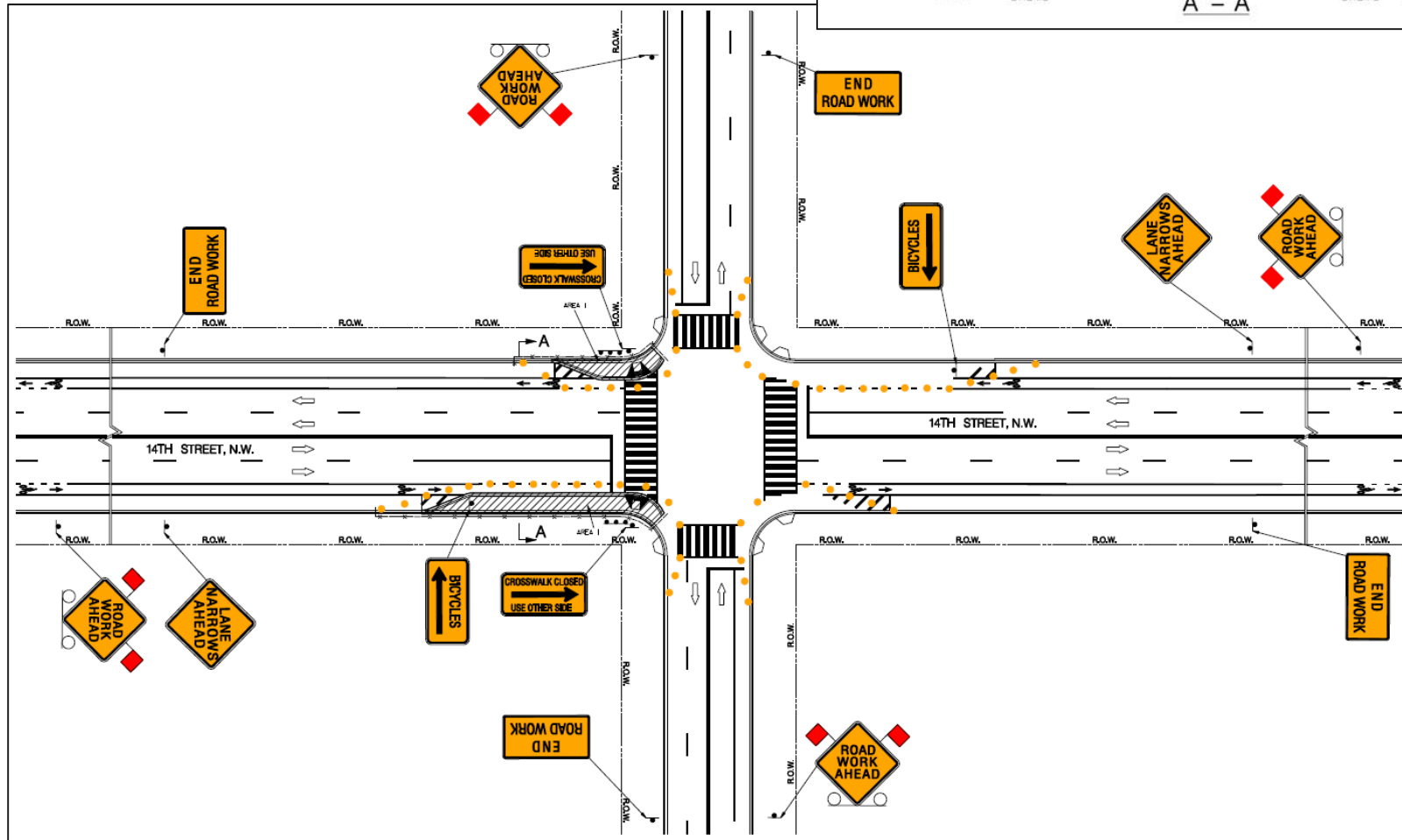

MOT DETAILS

Sidewalk Construction

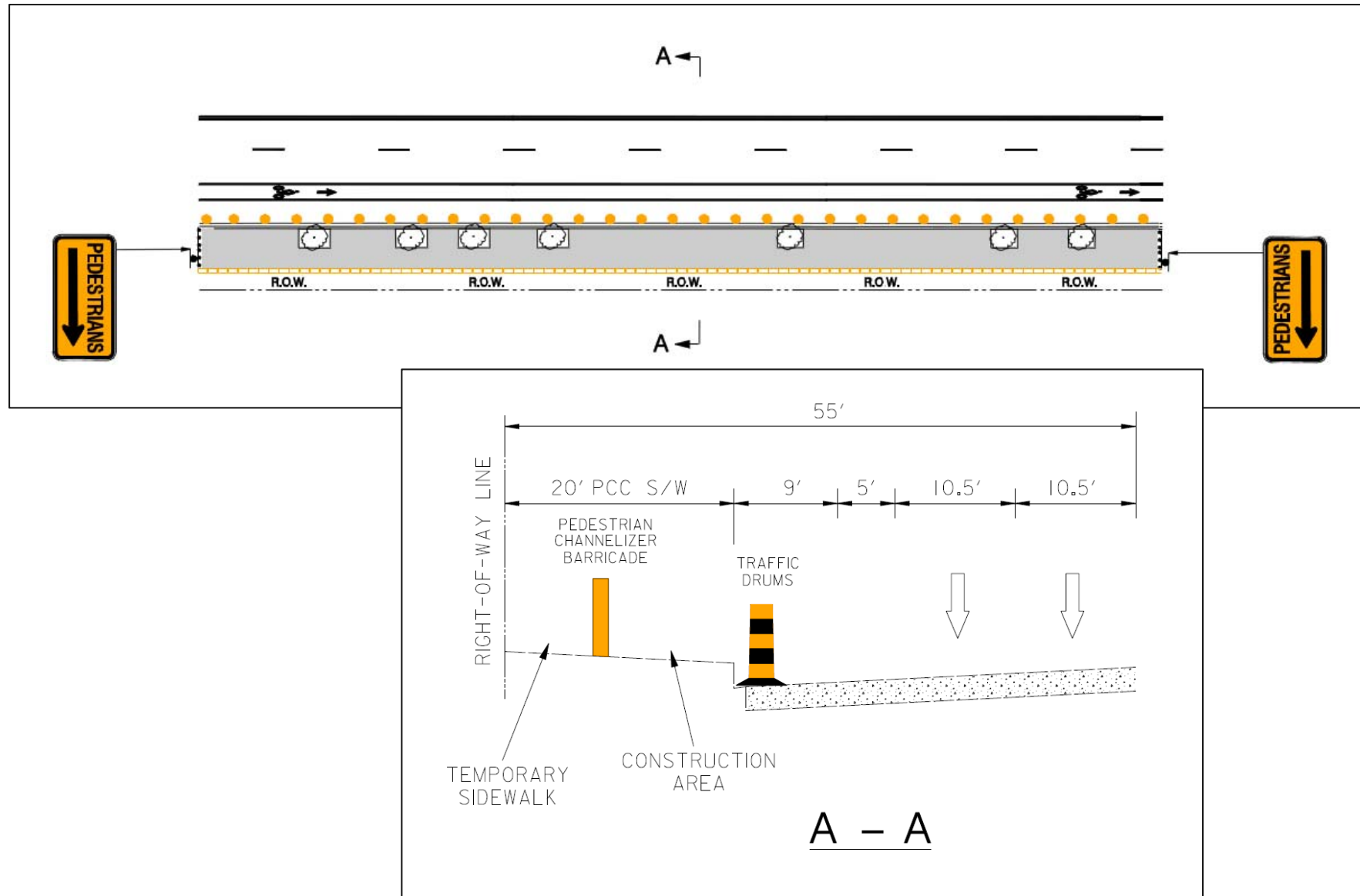

MOT DETAILS

Channelized Sidewalks



PROJECT CONTACT

Project Manager:

Kadidjatou Ayeva

Phone: 202-671-4553

Kadidjatou.Ayeva@dc.gov

THANK YOU

Questions?

